

BEAMSHOT™ 1000S/U Instructions

179

Thank you for buying the BEAMSHOT™ 1000S/U. This **Instruction** contains important safety directions and instructions for using this precision instrument. To ensure the optimal performance and longevity, please read this manual before operating your BEAMSHOT™ 1000S/U.



BEAMSHOT™

PART LIST

- A - BEAMSHOT™ 1000S/U
- B - Sleeve
- C - M1 mount

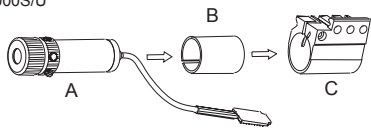

MISC. PARTS

- 1 - Allen wrench
- 1 - Nut
- 1 - Clamp plate
- 1 - Cap screw
- 1 - Elastic band

INSTALLATION PROCEDURES

I. Replacing the Batteries

1. Unscrew the rear cap, remove used batteries and insert one new CR123A battery as shown.



Fig. A

II. Mounting the BEAMSHOT™ 1000S/U on your weapon - For any Pistol and Rifle which have Imbedded Weaver Base. Example: Glock 17

Warning: Please make sure the weapon is pointing away from you while mounting and sighting in the Laser Sight.

1. Slide the BEAMSHOT™ 1000S/U with the sleeve into the M1 Mount (Fig. B).

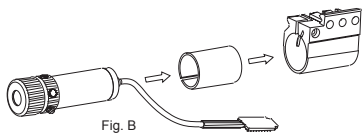

Fig. B

2. Rotate the BEAMSHOT™ 1000S/U so that the metal cap and adjustment screws are in the correct positions as shown in Fig. C.

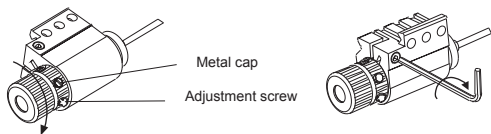

Fig. C

Fig. D

3. Clamp the M1 Mount by tightening the Cap Screw with the Allen Wrench as shown in Fig. D

4. Attach the BEAMSHOT™ 1000S/U to the barrel. Fasten the Clamp Plate with the Cap Screw and the Nut (Fig. E).

Note: The M1 Mount has three screw setting holes. Choose one of them for best fitting position (Fig. F).

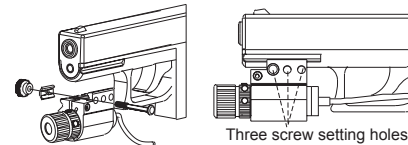

Fig. E

Fig. F

5. Affix the Velcro side of the activation button to the elastic band and position appropriately on the grip.

III. Zeroing in of the BEAMSHOT™ 1000S/U on your gun (Fig. G)

1. Loosen the mount screws or housing screws (depending on which you are using) that hold the laser sight. Please insure the windage and elevation adjustments are in the correct position as shown in Fig. F
2. Make sure your adjustment screws are accessible.
3. Lock the BEAMSHOT™ 1000S/U into position by tightening either the housing screws or the mount screws depending on the mount you are using.

Note: The screw between the two metal caps is the locking screw. This screw is not used to adjust the windage or elevation.

4. Turn the locking screw loose little by little.
5. Fine tune the windage and elevation adjustments to zero in on your open sights at the desired distance.
6. Tighten the locking screw.
7. Once locked - the dot might move a little.
8. Repeat steps 1-3 until precisely zeroed in.

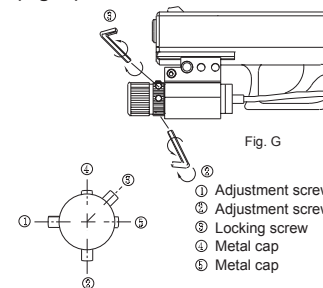

The above adjustment is accurate to the open sight. To ensure your BEAMSHOT™ 1000S/U is zeroed on your bullet trajectory at a certain distance, go to the shooting range and shoot at the target. Using the above steps, sight in on your point of impact on the target. This enables you to sight in on your bullet.

TROUBLESHOOTING:

- A. Are you using the BEAMSHOT™ 1000S/U & BEAMSHOT™ Mount?
- B. Are you installing the correct Mount? (Please check our brochure)
- C. Locking screw is not tight enough.
- D. The Cap Screws are not tight enough.

- E. Spot check mount screws.
- F. If you find a mirror dot at a short distance, this means the laser intensity is higher. This will not bother you at your normal shooting distance. You can get rid of this by adjusting your laser at a different angle.

SPECIFICATIONS:

- Available colors: black or silver
- Dimensions: 2.72" (L) x 0.75" (P)
- Weight: 3.8oz. (incl. battery)
- Construction: Aluminum 6061 T6
- Operation: Removable finger-touch pressure switch
- Battery: 1 CR123A lithium battery

- Battery Life: 20 Hrs. constant "ON"
- Power: Less than 5mW, Class IIIa
- Wavelength / Range:
 - 1000S: 650nm / 500 yards ; 1000U: 635nm / 800 yards
- Dot Size: 1/2" @ 10 yards, 4" @ 100 yards
- Windage & Elevation adjustment: 3 Ft. @ 10 yards, 30 Ft. @ 100 yards

*Note: BEAMSHOT™ 1000S/U is also compatible with other mounts in the BEAMSHOT™ line.

CAUTION: Use of controls or adjustments, or performance of procedures other than those specified herein may result in hazardous radiation exposure.

