

Night Stalker X6 / X15 / X30 / T30

Enhances Night Vision Device Performance

The Night Stalker series uses state of art technology of 3W IR Laser Diode with 6.5-30 degree laser beam for maximum illumination to enhance Night Vision Device, Scope or IR Camera performance. Extremely small size and light weight but the most powerful IR laser illumination to makes it easy to carry as an IR Torch or mount onto weapon for NVD, digital scope or camera. It enables all levels of tactical situation, self-defense and hunting. Series products provide a night solution for close to long range target engagement. Built-in with IR Laser Illuminator can reduce the red glow that emits from front to avoid position exposure.



FEATURES

- 850nm class I eye safe FDA approved IR laser. Using 3W powerful laser beam is minimum 6.5 degree divergence for eye safe and long distance illumination.
- Smallest and lightest in the market - 3.6"(L) x 1.2"(Head) x 0.75"(Body) (92 mm x 30 mm x 19 mm) and 1.76 OZ (50g) only.
- Aircraft-grade hard-anodized aluminum with durable finish.
- Operating temperature range between -4°F ~ 140°F (-20°C ~ 60°C).
- Powered by one CR123A Battery for 1 hour battery life.
- Free picatinny 1913 rail mount included.
- IPX7 water proof.
- Minimum the red glow in front.

CAUTION

- **When not in use, always keep Switch at OFF position. Be careful there is very little red glow in front and need carefully to observe, please make sure switch is actually turned off to avoid battery drain.**
- **Battery** : The Night Stalker X6/X15/X30/T30 is powered CR123A Lithium battery.
- Do not allow water to enter the housing by keeping the battery cap shut.
- Do not store the Night Stalker X6/X15/X30/T30 with battery installed.
- Do not attempt to recharge.
- Do not install a defective battery in the Night Stalker X6/X15/X30/T30.
- Prior to operating, check to see all batteries for cracks, bulging, and leakage.
- Do not puncture, disassemble, short circuit.

DANGER

- Use of controls or performance of procedures other than those specified herein may result in hazardous radiation exposure.
- This laser product is classified as Class I according to 21 CFR 1040.
- Avoid all eye contact .Never look directly into the laser lens even if the laser is off.
- Do not look into the laser beam through binoculars or telescopes.
- Do not point the laser beam at reflective surfaces.
- Never aim the laser beam at persons'eyes.
- This unit must be used by experienced technical personnel only.
- Do not leave the laser beam unattended.
- Do not target vehicles or aircraft with the laser beam when the unit is used outdoors.
- Do not look directly into laser beam with optical instrumentation unless adequate protective filters are used to protect the eyes.
- Avoid aiming the laser beam at mirror- likes surfaces. Remove any unnecessary mirror-likes surface from the vicinity of the laser beam path.
- The warranty will no longer exist once the product been taken apart.

CONTENTS OF A SET

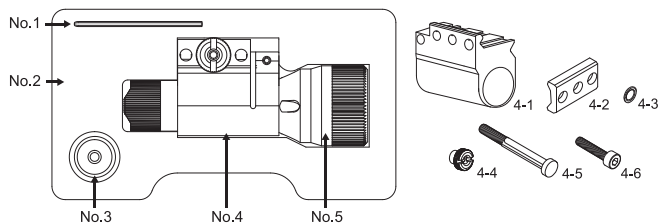

No	Part Name	Parts Stock Number(PSN)
1	Allen Wrench M1.5	428-025540-011G
2	Hard Covered Carrying Case	491-258130-021G
3	CR123A Battery	451-C0103G
4	M1 Mount	304Y90406G
4-1	M1 Mount Main Body	304790405G-3
4-2	Clamp Plate	406-59708G
4-3	Washer	428-5AV06G
4-4	Nut	427-06004G
4-5	Long Cap Screw	425-030300-001G
4-6	Short Cap Screw	424-030180-011G
5	Night Stalker Main Body	As Specifications

SPECIFICATIONS

Model	X6	X15	X30	T30
Beam Divergence	6.5°	15°	30°	30°
Part Stock Number(PSN)	257-B7002G	257-B7003G	257-B7004G	257-B7005G
Light Source	850 nm Class I eye safe laser			3W IR LED
Weight	1.76±0.35 oz. / 50±10 g			
Dimensions	3.6"(L) x 1.2"(Head) x 0.75"(Body)(92 x 30 x 19 mm)			
Construction	Aluminum 6061 T6 with durable finish.			
Mount	M1 Rail Mount			
Range (Night Time)	50 ~ 200 m	30 ~ 100 m	10 ~ 50 m	10 ~ 50 m
Operation	ON/OFF switch			
Operating Temperature	-4°F ~ 140°F		(-20°C ~ +60°C)	
Battery	1 x CR123A 1+ hour			

CONSTRUCTION

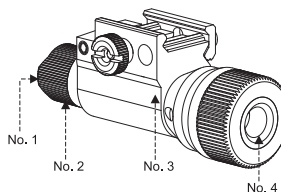

No.	Description
1	ON/OFF Switch
2	Battery Cap
3	M1 Mount
4	IR Laser Illuminator Aperture

BATTERY INSTALLATION

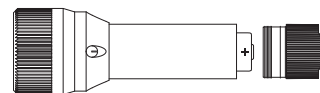

Unscrew battery cap, insert CR123A battery, positive pole face outside as Fig.

After battery installed, please always observe any red glow from front side to make sure switch is at "OFF" position.

Power Supply : One CR123A Battery (3.0 Volt)

NOTE :

Battery life is reduced when using rechargeable CR123A and Alkaline batteries CR123A. Do not store the Night Stalker X6/X15/X30/T30 with battery installed.

OPERATION

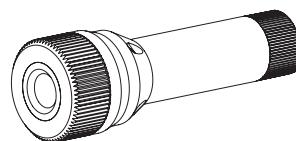

1. Press ON/OFF switch to fire IR Laser Illuminator.
2. Spot only visible with night vision equipment or IR camera.
3. Night Stalker X6/X15/X30/T30 dramatically increases the performance of any night vision scope, IR camera in low ambient light scenes.
4. **Please note: always press ON/OFF switch to "OFF" position after use to avoid battery drain.**

NOTE :

We guarantee the quality of workmanship of this product. Prior to shipping from our factory, stringent quality control measures of varying intensity are employed. Minor scratches on the mount may be evident, but is considered normal.

MOUNTING

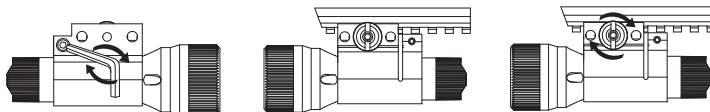

1. Clamp the M1 mount by tighten short cap screw with Allen Wrench as Fig.
2. Attached the unit onto rail base.
3. Firmly fasten the clamp plate with long cap screw and nut. Be sure washer is inserted between Nut and Clamp plate.